

2010/28

Greenheath Planned Unit Development (extension of the 2010 sunset date) involving 97.80 acres of Lady's Island, for an additional ten years with conditions

2010/28

Greenheath Planned Unit Development (extension of the 2010 sunset date) involving 97.80 acres of Lady's Island, for an additional ten years with conditions

2010 / 28

AN ORDINANCE OF THE COUNTY OF BEAUFORT, SOUTH CAROLINA, TO EXTEND THE 2010 SUNSET DATE FOR GREENHEATH PLANNED UNIT DEVELOPMENT, INVOLVING 97.80 ACRES ON LADY'S ISLAND, FOR AN ADDITIONAL TEN YEARS WITH CONDITIONS:

- Concurrent with this PUD action, the applicant shall address school deficiencies through a development agreement with Beaufort County.
- Improved access shall be provided between the development and Coosa Elementary. If golf cart type vehicles are envisioned for Greenheath residents, then connectivity to the school should allow for golf cart type vehicle access.
- The landscape buffer along Brickyard Point Road shall include a 15-foot easement to allow construction of a future 10-foot wide multi-use pathway.
- Incorporation of environmental development requirements of the ZDSO.
- Providing for all current impact fees to apply to this PUD.
- A Development Agreement must accompany this PUD and include, the sunset date for this project.

Adopted this 29<sup>th</sup> day of November, 2010.

COUNTY COUNCIL OF BEAUFORT COUNTY

By:

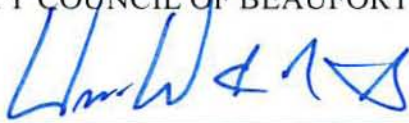

Wm. Weston J. Newton, Chairman

APPROVED AS TO FORM:

  
Ladson F. Howell, County Attorney

ATTEST:

  
Suzanne M. Rainey, Clerk to Council

First Reading: August 25, 2008

Second Reading: October 26, 2009

Public Hearings: November 9, 2009 and November 29, 2010

Third and Final Reading: November 29, 2010



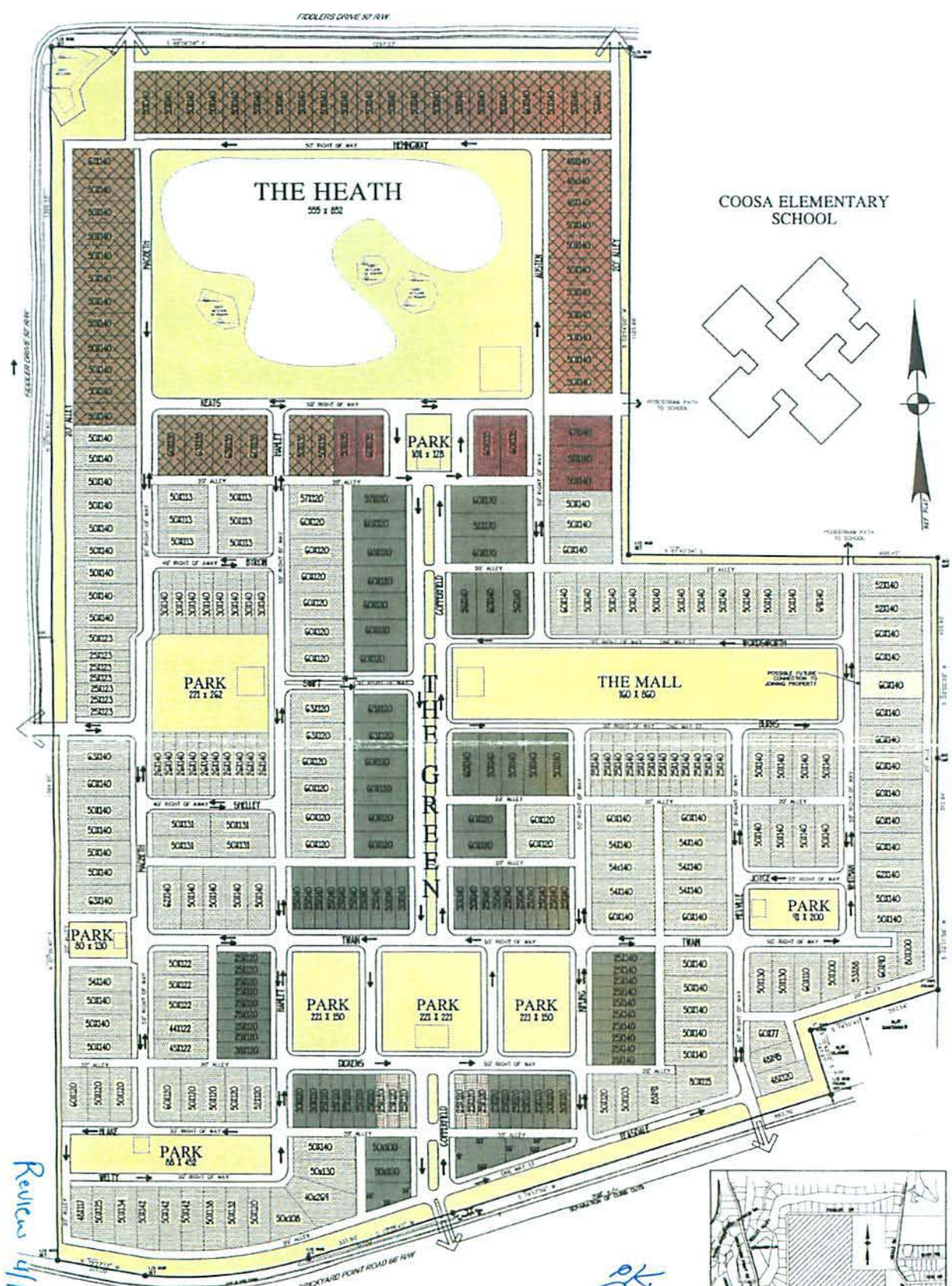

Review  
4/19/05

OK  
4/15/05

- THE HEATH
  - VILLAGE GENERAL
  - THE GREEN
  - COMMERCIAL ONLY
  - COMMUNITY COMMERCIAL
  - POSSIBLE CIVIC SITES
- DWELLING UNITS: 313  
 COMMERCIAL: 25,000 sq. ft.  
 TOTAL ACREAGE: 98.35

EXHIBIT A-2  
 SCALE: 1" = 200'  
**GREENHEATH**  
 a traditional neighborhood  
 revised PLD Master Plan 01/19/05

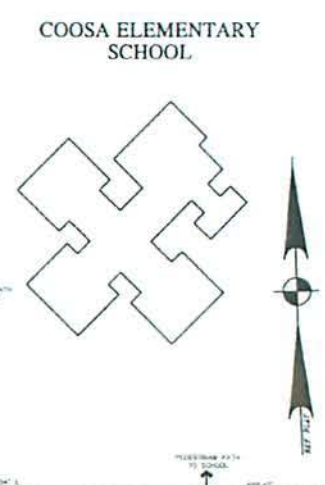

ALLISON RAMSEY  
**ARCHITECTS**  
 Members of the American Institute of Architects



# R-200-10-22 Greenheath PUD Amendment

Application for extension of expiration date beyond December 31, 2010

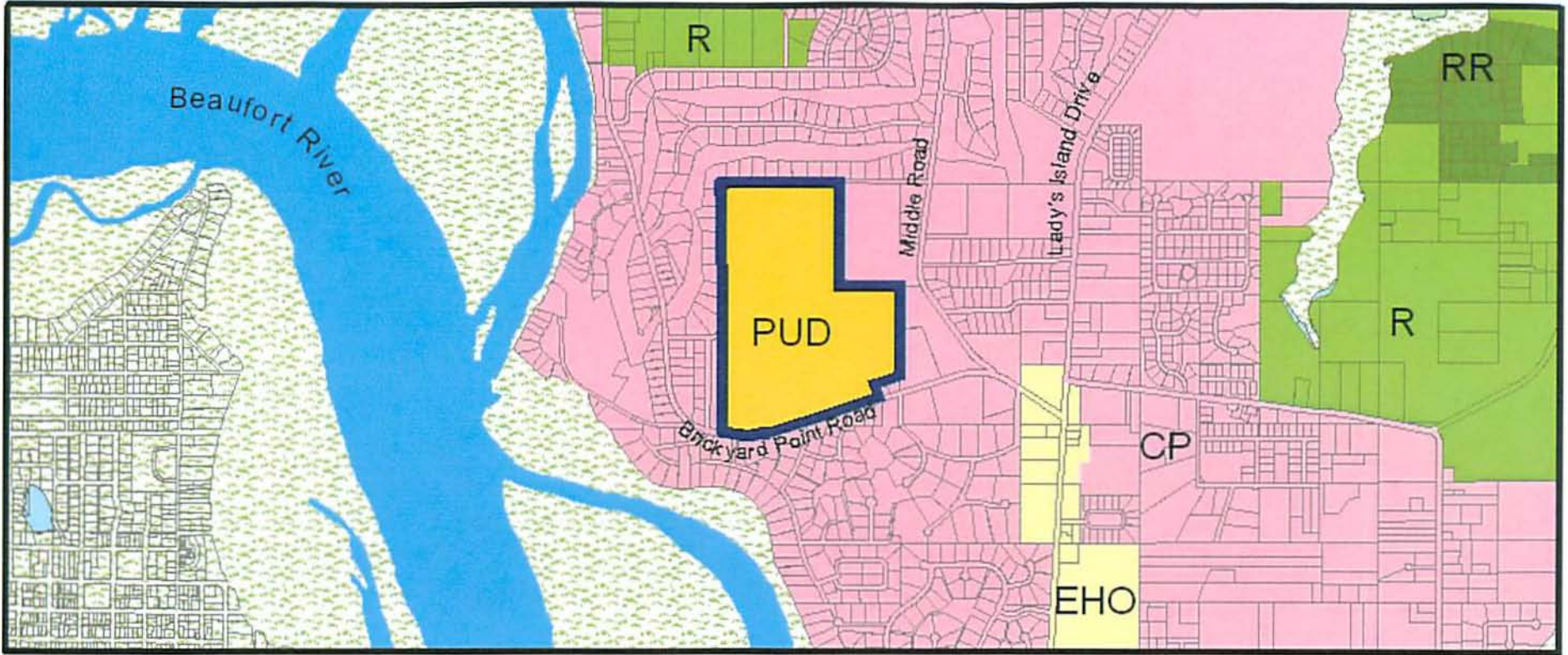

## Legend

-  R-200-10-22
-  Planned Unit Development (PUD)
-  Community Preservation (CP)
-  Rural (R)
-  Rural Residential (RR)
-  Expanded Home Office (EHO)

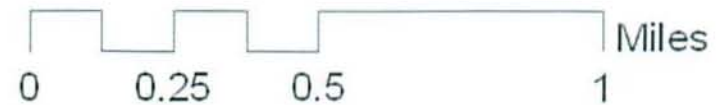

Beaufort County Planning Department