

2011 / 26

BEAUFORT COUNTY ZONING MAP AMENDMENT (MASTER PLAN AMENDMENT) FOR R300 009 000 0050 (KNOWN AS OAK ISLAND), PART OF THE DATAW ISLAND PLANNED UNIT DEVELOPMENT/PUD, 31.7 ACRES ADJACENT TO DATAW ISLAND, TO ALLOW 21 DUPLEX UNITS (42 TOTAL DWELLING UNITS) RATHER THAN THE 35 SINGLE FAMILY DWELLING UNITS ORIGINALLY APPROVED.

BE IT ORDAINED, that County Council of Beaufort County, South Carolina, hereby amends the Zoning Map of Beaufort County, South Carolina. The map is attached hereto and incorporated herein.

Adopted this 12<sup>th</sup> day of September, 2011.

COUNTY COUNCIL OF BEAUFORT COUNTY

By: 

Wm. Weston J. Newton, Chairman

APPROVED AS TO FORM:

  
Ladson F. Howell, Staff Attorney

ATTEST:

  
Suzanne M. Rainey, Clerk to Council

First Reading: August 8, 2011  
Second Reading: August 22, 2011  
Public Hearing: September 12, 2011  
Third and Final Reading: September 12, 2011

(Amending 99/12)



**MAP AMENDMENT**  
For Oak Island - a part of Dataw Island PUD  
R300 009 000 0050 0000

- ST HELENA ISLAND  
ZONE DISTRICT**
- [RC] Resource Conservation
  - [R] Rural
  - [CP] Community Preservation
  - [PUD] Planned Unit Development



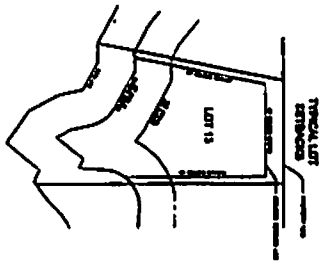
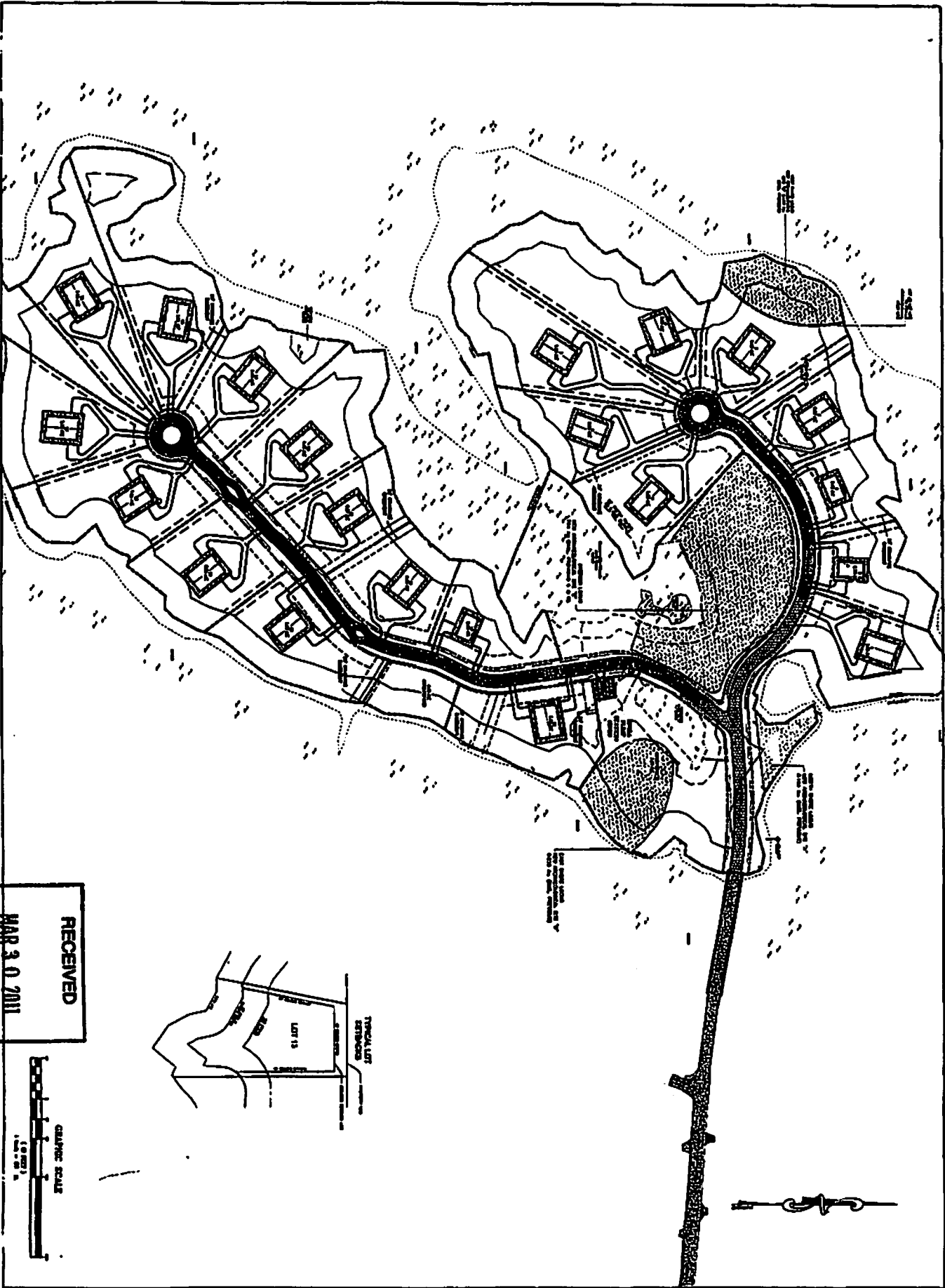

RECEIVED  
 MAR 30 2011  
 PLANNING  
 DIVISION



HOUSE LAYOUT  
 1  
 OF 1

**OAK ISLAND  
 OAK ISLAND DRIVE  
 BRAUFORT COUNTY, SC**

**CAROLINA ENGINEERING CONSULTANTS, INC.**  
 300 WEST 2ND STREET  
 BRAUFORT, SC 29516

REGISTERED PROFESSIONAL ENGINEERS  
 STATE OF SOUTH CAROLINA  
 LICENSE NO. 10000

PLAN REVISIONS		
NO.	DESCRIPTION	DATE
1	ISSUED FOR PERMITS	
2		
3		
4		
5		
6		
7		
8		

Carolina Engineering Consultants, Inc.  
 License No. 10000

THIS SEAL IS VALID FOR THE STATE OF SOUTH CAROLINA. THE SEAL IS VALID FOR THE STATE OF SOUTH CAROLINA. THE SEAL IS VALID FOR THE STATE OF SOUTH CAROLINA.



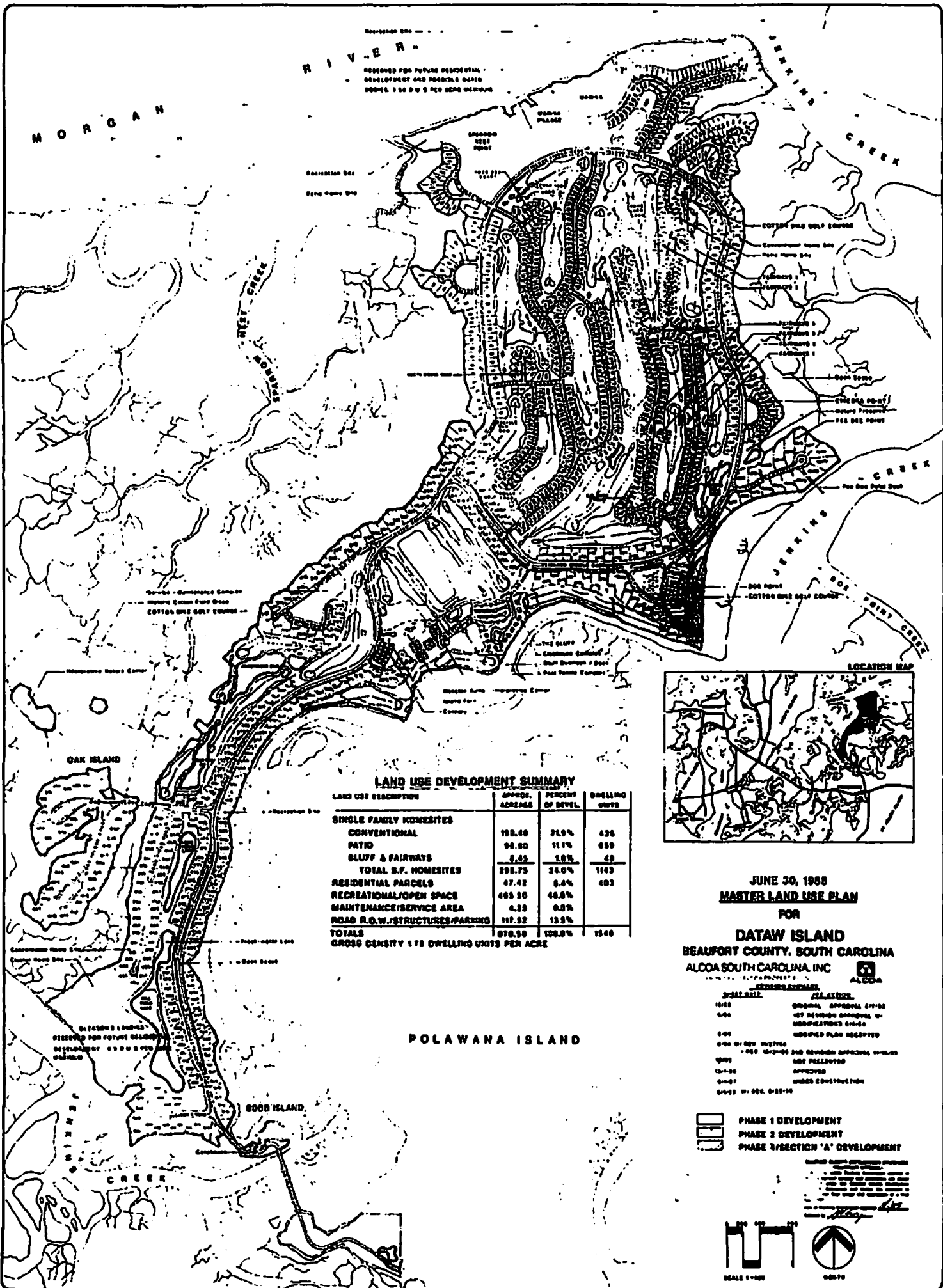

RESERVED FOR FUTURE RESIDENTIAL DEVELOPMENT AND POSSIBLE HOTEL ROOMS. 1.50 D.U.'S PER ACRE MAXIMUM

RESERVATION SEE PAGE THREE SHEET

**LAND USE DEVELOPMENT SUMMARY**

LAND USE DESCRIPTION	APPROX. ACREAGE	PERCENT OF ISLAND	DWELLING UNITS
<b>SINGLE FAMILY HOMESITES</b>			
CONVENTIONAL	192.40	21.9%	426
PATIO	96.80	11.1%	630
BLUFF & FAIRWAYS	2.45	1.0%	40
<b>TOTAL S.F. HOMESITES</b>	<b>291.75</b>	<b>34.0%</b>	<b>1140</b>
RESIDENTIAL PARCELS	47.42	5.4%	403
RECREATIONAL/OPEN SPACE	465.35	48.8%	
MAINTENANCE/SERVICE AREA	4.25	0.5%	
ROAD R.O.W./STRUCTURES/PARKING	117.52	13.3%	
<b>TOTALS</b>	<b>876.99</b>	<b>100.0%</b>	<b>1540</b>

GROSS DENSITY 1.75 DWELLING UNITS PER ACRE



**JUNE 30, 1958**  
**MASTER LAND USE PLAN**

FOR  
**DATARW ISLAND**  
BEAUFORT COUNTY, SOUTH CAROLINA  
ALCOA SOUTH CAROLINA, INC.

- APPROVALS:**
- 12-12-58 APPROVED
  - 1-10-59 APPROVED
  - 2-10-59 APPROVED
  - 3-10-59 APPROVED
  - 4-10-59 APPROVED
  - 5-10-59 APPROVED
  - 6-10-59 APPROVED
  - 7-10-59 APPROVED
  - 8-10-59 APPROVED
  - 9-10-59 APPROVED
  - 10-10-59 APPROVED
  - 11-10-59 APPROVED
  - 12-10-59 APPROVED

**PHASE 1 DEVELOPMENT**  
**PHASE 2 DEVELOPMENT**  
**PHASE 3/SECTION 'A' DEVELOPMENT**

